

Maxi Move

From chair

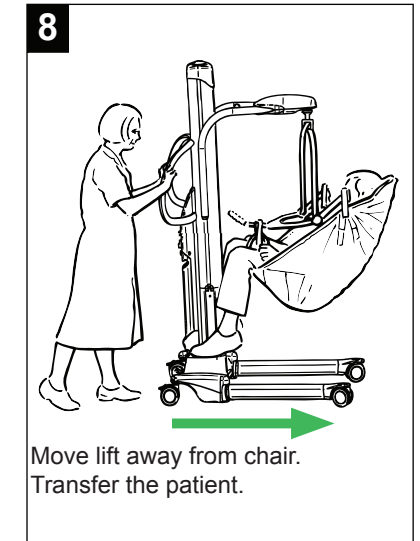

From bed

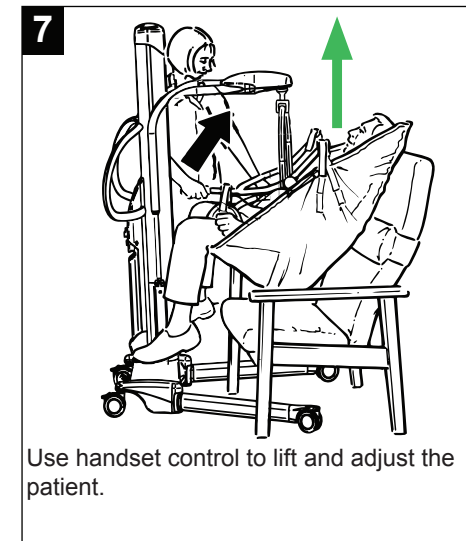
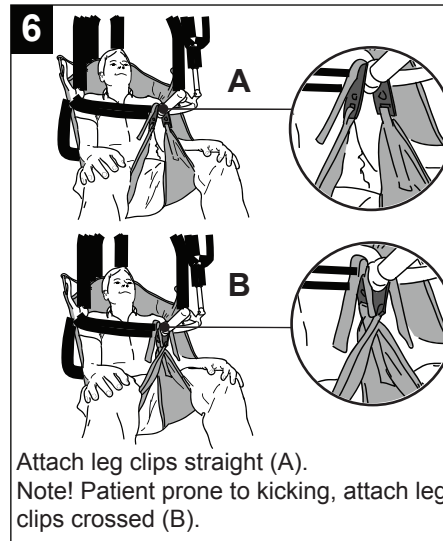
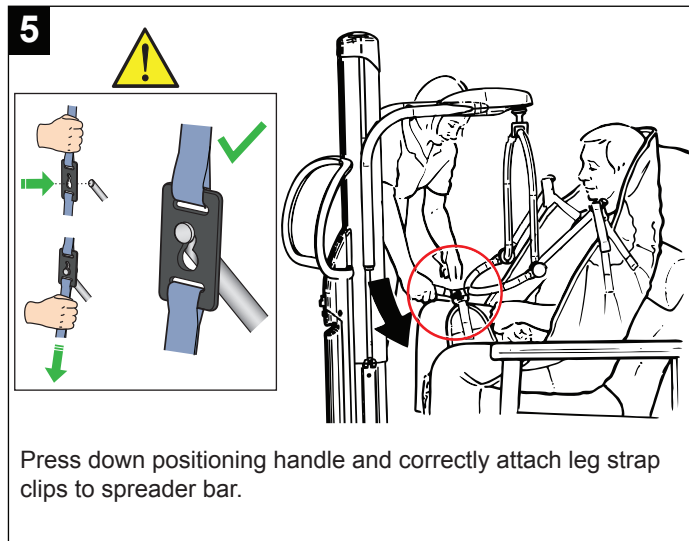
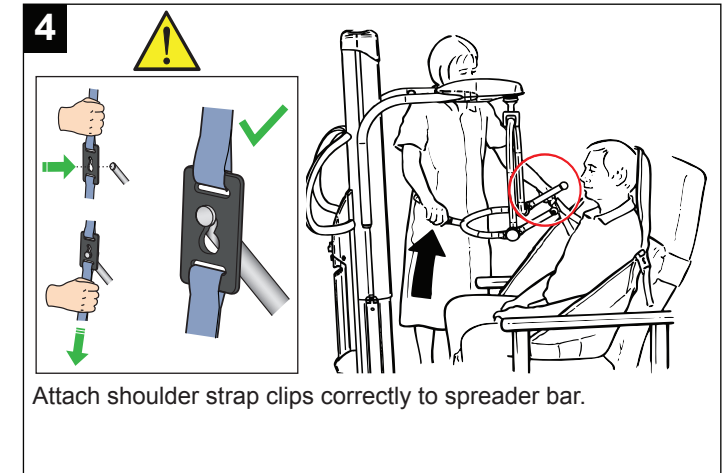
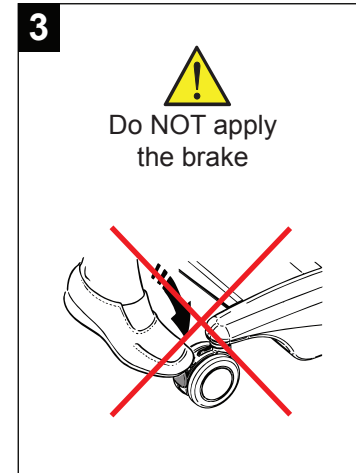
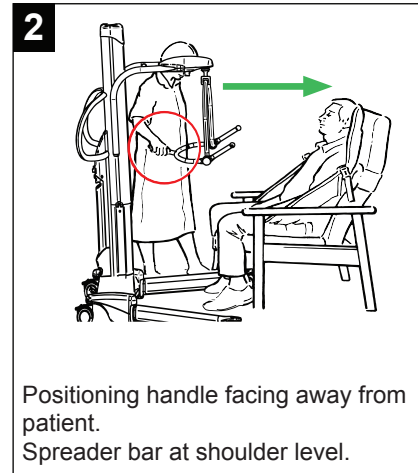
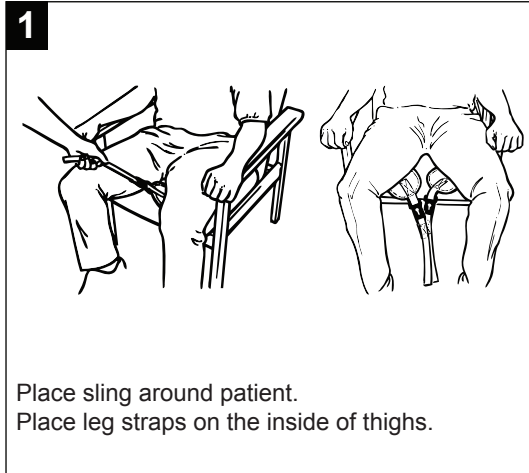
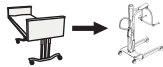

1

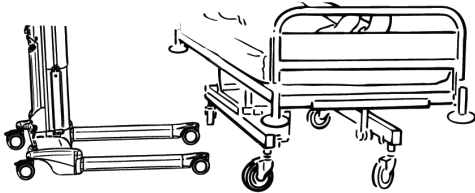

Check clearance for chassi legs under bed.

2

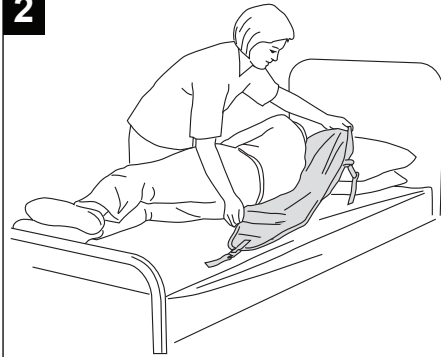

Place sling under patient.

3

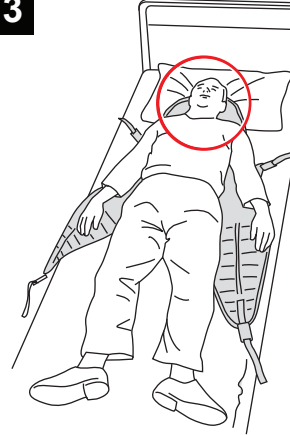

Sling head support area under patient's neck.

4

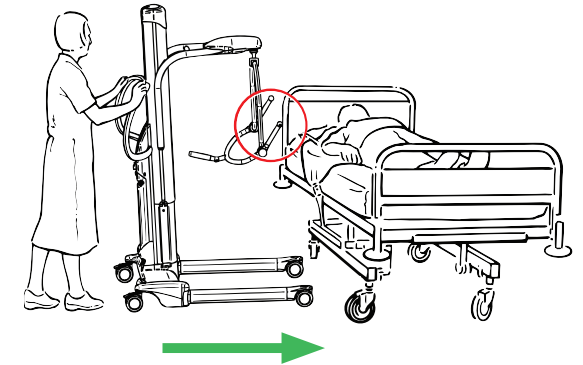

Approach bed with open side of spreader bar towards patient's head. Adjust chassis leg width if necessary.

5

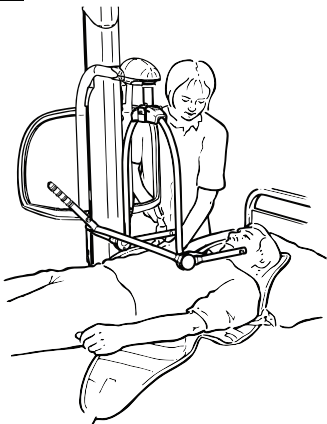

Position spreader bar above and centred over patient.

6

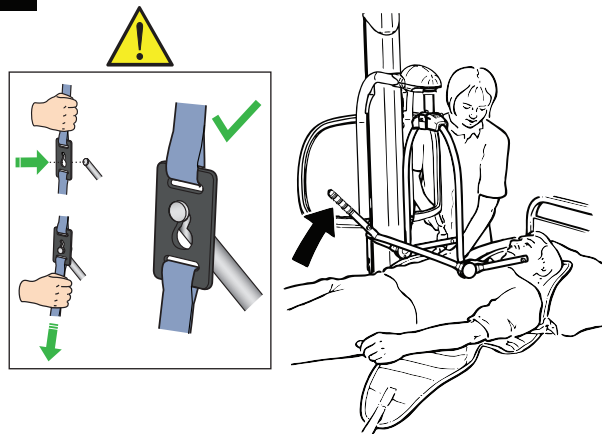

Use positioning handle to tilt spreader bar. Attach shoulder strap clips correctly to spreader bar.

7

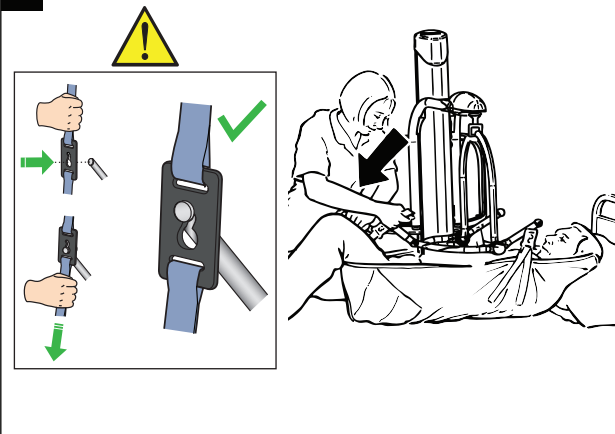

Press down positioning handle and correctly attach leg strap clips under thighs to spreader bar.

8

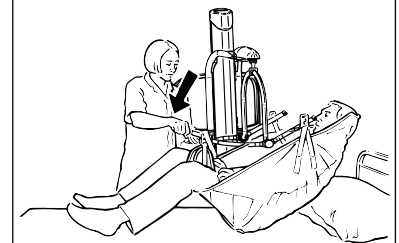

Lift and transfer the patient