

Century



- To avoid eye and skin damage, always use protective glasses and gloves. If contact occurs rinse with plenty of water. If eyes or skin becomes irritated, contact a physician.
- To prevent cross-contamination, always follow the disinfection instructions in the Instructions for Use.
- To avoid eye or skin irritation, never disinfect in the presence of a patient.
- Always read the instructions of the disinfectant.

Caregiver obligations

Clean and disinfect Century before every use.

Clean and disinfect with spray handle or spray bottle (Still bath and Hydrosound system only.)

Remove visual residue

1. Check the level of disinfectant in the disinfectant bottle.
2. Make sure all functions are turned off.
3. Open the drain to empty any left over water.
4. Detach and place accessories at the bottom of the bathtub.
5. Press the Patient Shower button on the control panel.
6. Shower and rinse the bathtub and the accessories to remove visible residue. Turn the accessories and rinse again.

Clean

7. Put on protective gloves and protective glasses.
8. Open the access door on the left side of the panel and lift out the disinfection spray handle or use a disinfection spray bottle.
9. **For disinfection spray handle only:** Direct the disinfectant spray towards the bottom of the bathtub and press the Disinfection button on the control panel.
10. **For disinfection spray handle only:** Adjust water temperature so it reaches approximately 25 °C (77 °F) to eliminate disinfectant fumes.
11. Spray disinfectant in the bathtub and check disinfectant mix ratio on flow meter to make sure it is within the stated range (see Instructions for Use).
12. Spray disinfectant in the drain.
13. Scrub the drain with a long handled brush.
14. Close the drain.
15. Spray disinfectant on all internal bathtub surfaces and accessories. Pay attention to knobs and sensors attached to the bathtub surface such as drain control knob and surface overflow outlet.
16. Spray disinfectant into the surface overflow outlet.
17. **For disinfection spray handle only:** Press the Disinfectant button on the control panel to turn it off, and place the disinfectant spray handle back behind the access door.
18. Scrub the surface of the bathtub, loose parts and accessories with a soft bristle brush or cloth. Scrub thoroughly, especially on the handles and hand controls.
19. Open the drain.
20. Press the Patient Shower button on the control panel.
21. Rinse all parts clean with plenty of water having a temperature of approximately 25 °C (77 °F) to remove disinfectant.
22. Soak cloth in a disinfectant.
23. Wipe all other contact areas with the cloth, such as the outside of the bath, sensors and hand control.

24. Wet a new cloth with water and remove all traces of disinfectant on contact areas. Rinse the cloth occasionally with running water.
25. Examine the bathtub and accessories to make sure that all of the disinfectant is removed. Repeat rinse if necessary.
26. Examine bathtub and accessories for visible damage.

Disinfect

27. Open the access door on the left side of the panel and lift out the disinfection spray handle or use a disinfection spray bottle.
 28. **For disinfection spray handle only:** Direct the disinfectant spray towards the bottom of the bathtub and press the Disinfection button on the control panel.
 29. Close the drain.
 30. **For disinfection spray handle only:** Adjust water temperature so it reaches approximately 25 °C (77 °F) to eliminate disinfectant fumes.
 31. Spray disinfectant on all internal bathtub surfaces and accessories. Turn the accessories and spray and on the other side. Pay attention to knobs and sensors attached to the bathtub surface.
- After using the disinfectant for a period of time, the system stops and is locked for a predefined time to ensure disinfectant contact time. The LED on the Disinfection button is lit until the system is unlocked.
32. **For disinfection spray handle only:** Press the Disinfection button on the control panel to turn it off, and place the disinfectant spray handle back behind the access door.
 33. Allow appropriate contact time according to the instructions of the disinfectant.
 34. Open the drain.
 35. Press the Patient Shower button on the control panel.
 36. Rinse all parts clean with plenty of water having a temperature of approximately 25 °C (77 °F) to remove disinfectant.
 37. Soak a cloth in disinfectant.
 38. Wipe all other contact areas such as the outside of the bathtub, sensors and hand control with the cloth.
 39. Allow appropriate contact time according to the instructions of the disinfectant.
 40. Wet a new cloth with water and remove all traces of disinfectant on contact areas. Rinse the cloth occasionally in running water.
 41. Leave to air dry.
 42. Attach any accessories.

Clean and disinfect Hydromassage System with Automatic Disinfection

This procedure is a complement when cleaning the bath system.

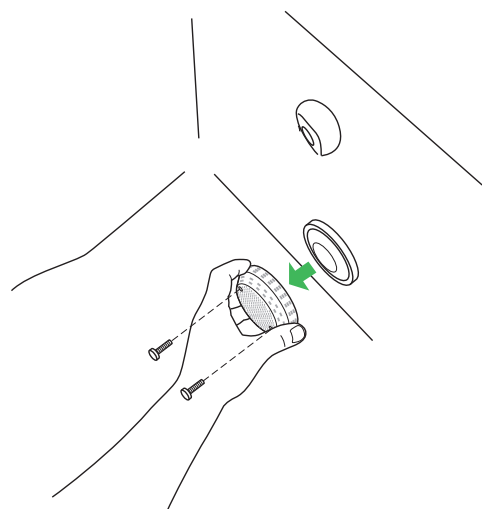

Figure 1

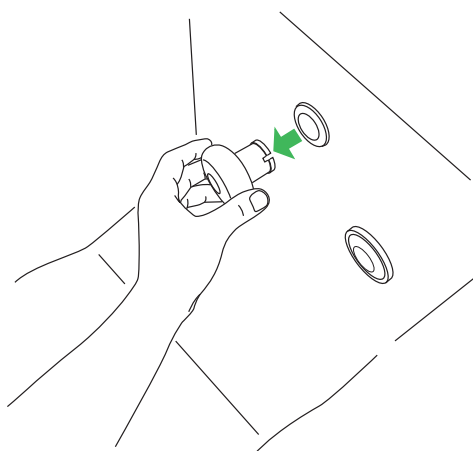

Figure 2

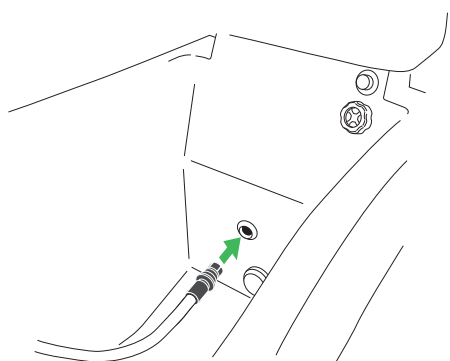

Figure 3

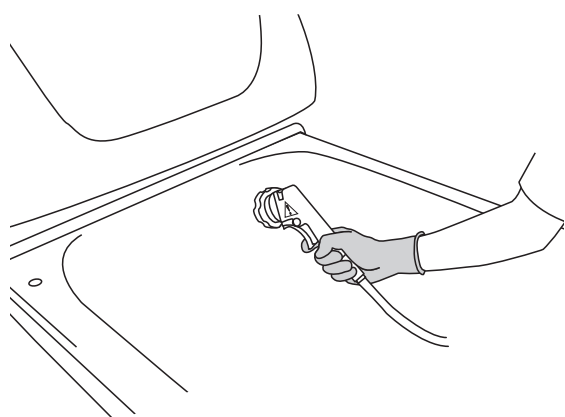

Figure 4

1. Check the level of disinfectant.
2. Open the drain.
3. Remove the suction inlet screen and clean it separately. See Figure 1.
4. **For treatment hose only:** pull out the Hydromassage system nozzle and clean it separately. See Figure 2.
5. **For treatment hose only:** Insert the treatment hose in the Hydromassage system outlet. See Figure 3.
6. Press the Disinfection button on the control panel to start the automatic disinfection cycle. Disinfectant is flushed through the Hydromassage system nozzle/treatment hose. The disinfectant cycle ends with the Hydromassage system being rinsed with water.
7. **For treatment hose only:** When the disinfectant cycle is completed, remove the treatment hose and let it hang dry on the holder. Place the Hydromassage system nozzle back into the Hydromassage system outlet.
8. Open the access door on the left side of the panel and lift out the disinfection spray handle or use a disinfection spray bottle.
9. **For disinfection spray handle only:** Direct the disinfectant spray towards the bottom of the bathtub and press the Disinfection button on the control panel.
10. Spray disinfectant into the surface overflow outlet. See Figure 4.
11. **For disinfection spray handle only:** Press the Disinfection button on the control panel to turn it off, and place the disinfectant spray handle back behind the access door.
12. Allow appropriate contact time according to the instructions of the disinfectant.
13. When disinfection is completed, reassemble the suction inlet screen.
14. Press the Patient Shower button on the control panel.
15. Rinse all treated parts clean with plenty of water having a temperature of approximately 25 °C (77 °F) to remove disinfectant.

Continue with remaining disinfection instructions according to section Disinfect (step 27-42 on page 1).

