

Håndkontroll

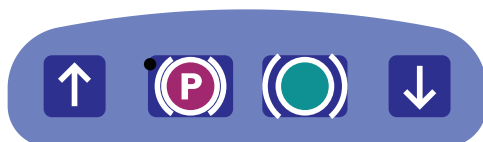

Kontrollpanel



Løft liggeplaten.



Senk liggeplaten.



Hev ryggstøtten.



Senk ryggstøtten.



Sett på sentralbremsen.
Blinkende lys = bremsene er koblet inn.



Frigjør sentralbremsen.

Nødstop



Nødløfting/-senking

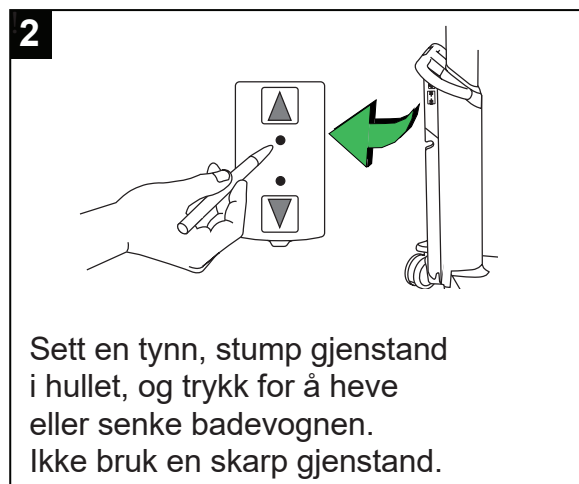
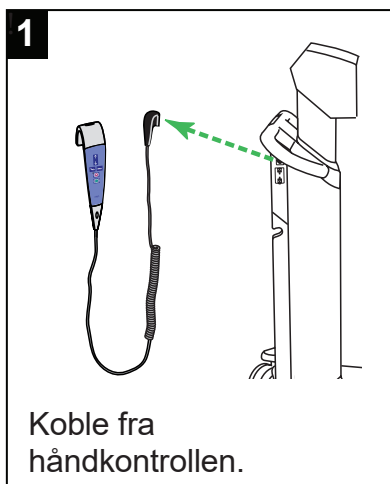

Ryggstøtte og wirefeste

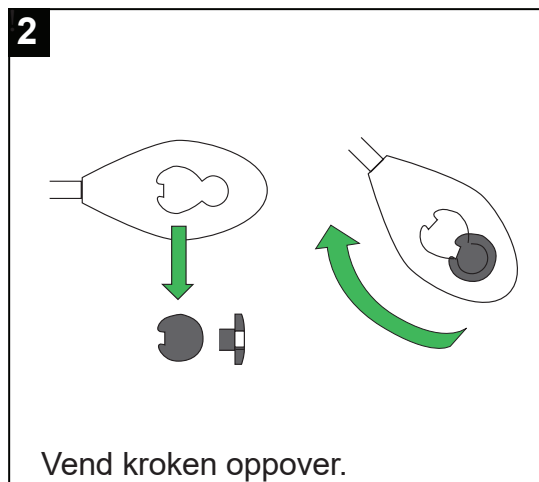
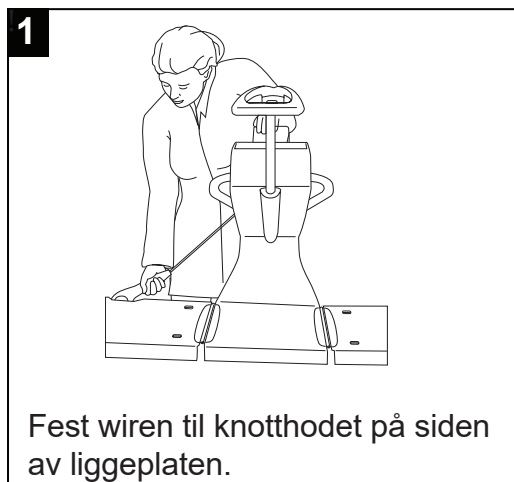

Sidebeskyttelse og sikkerhetsgrep for pasient

1

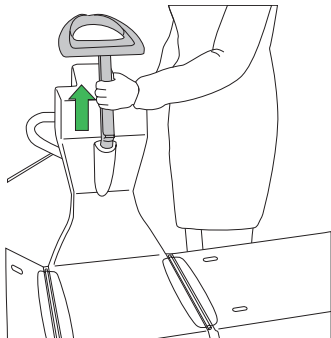

Løft håndtaket oppover.

2

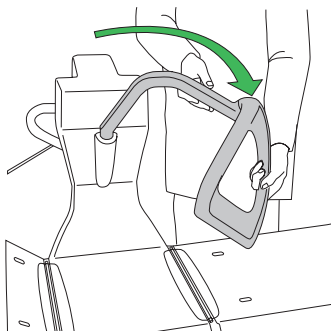

Senk håndtaket vekk fra pasientens hode.

3

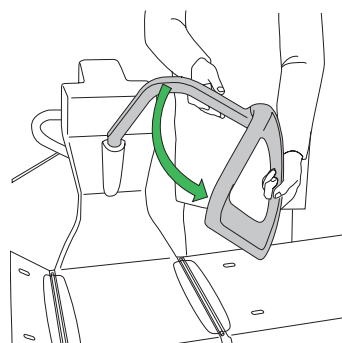

Plasser sidebeskyttelsen.

Elektrisk drift

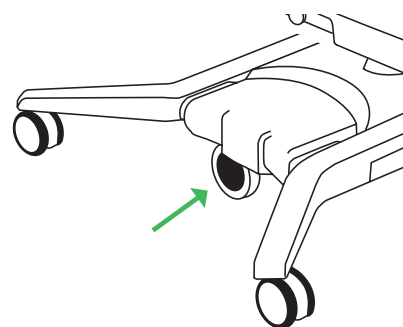
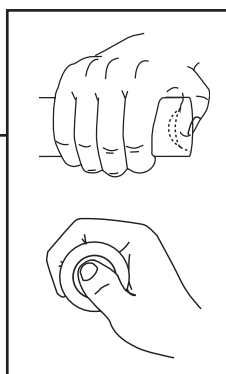
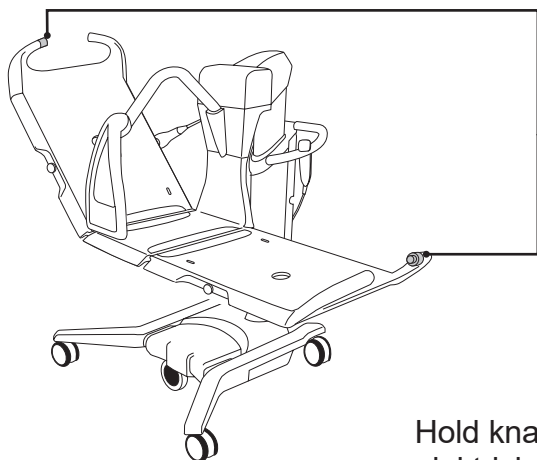

Hold knappen inne for å senke det femte hjulet og starte den elektriske drivmotoren.

Støttepute for lår

Slik festes den

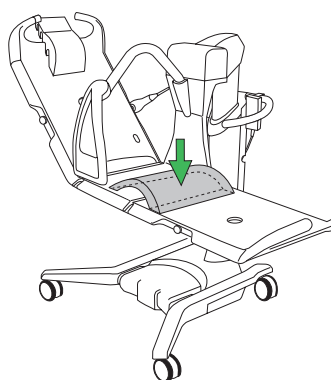

Slik tas den ut

