

Bolero

Emergency stop

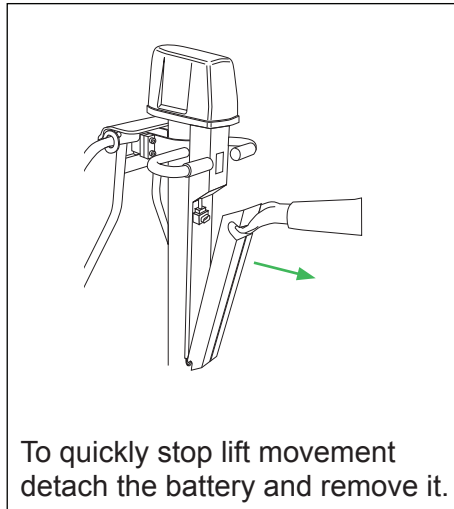

Emergency high and low

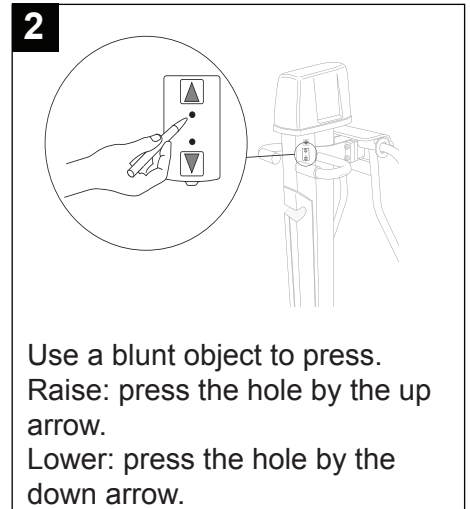

Manual raising and lowering

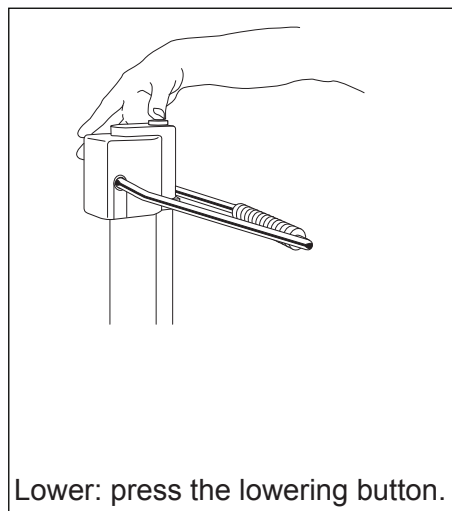
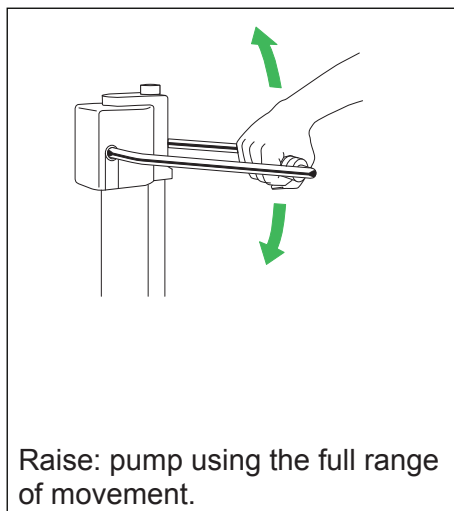

Electric raising and lowering

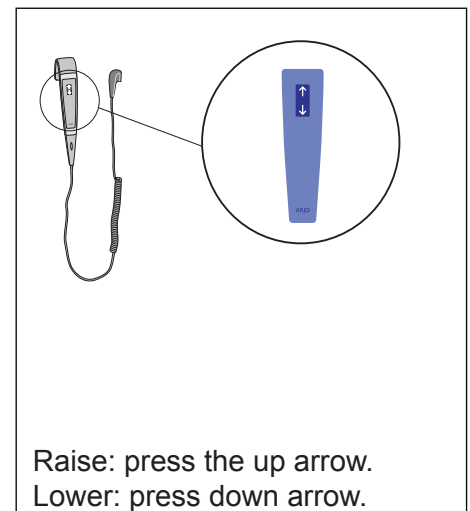

Brakes

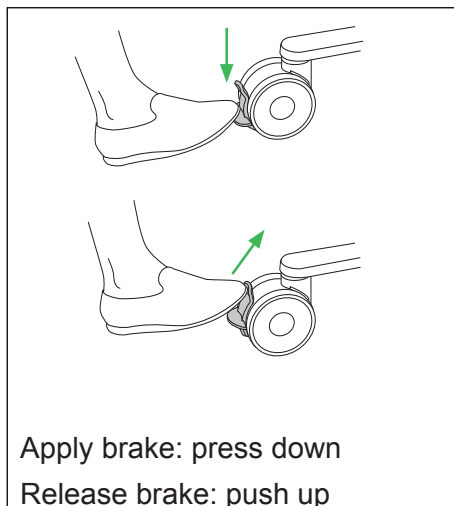

Backrest

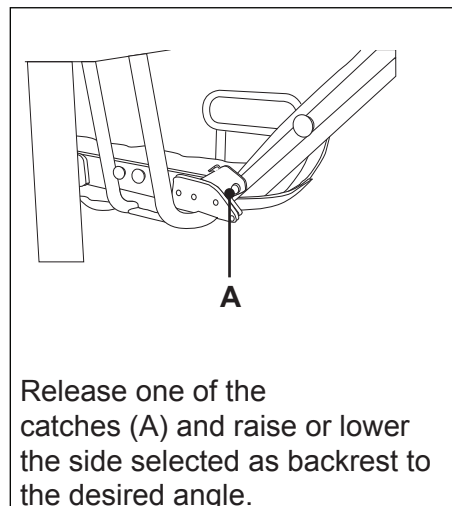

Handlebars

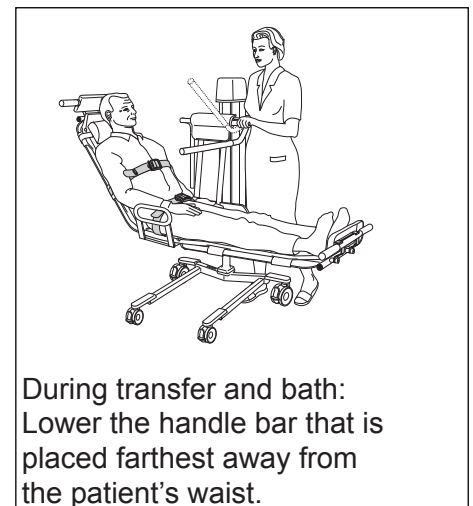

Attach mattress

1



Always start from the edge of the side strip when attaching or detaching the mattress.

2

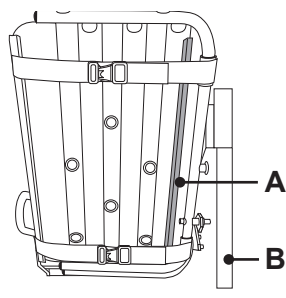

Attach the side strip (A) round the side of the stretcher next to the hydraulic pillar (B). Press and drag the palm along the side strip to fasten.

3

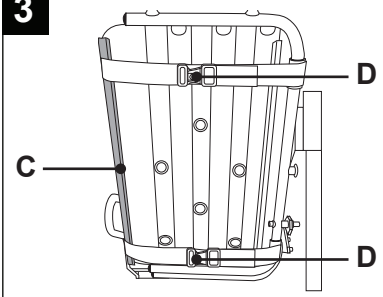

Stretch the mattress and fasten the other side strip (C). Fix the mattress in place with the quick grips (D).

Adjustment stretcher length

1

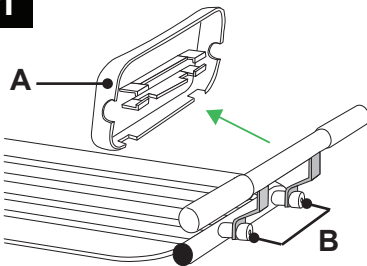

Remove the head or foot support (A) and undo the screws (B).

2

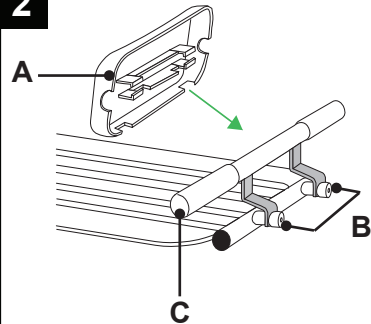

Rotate the transfer handle (C) 180°. Fasten the head or foot support (A) and the screws (B).

