

# Enterprise 9000X

## CPR backrest release

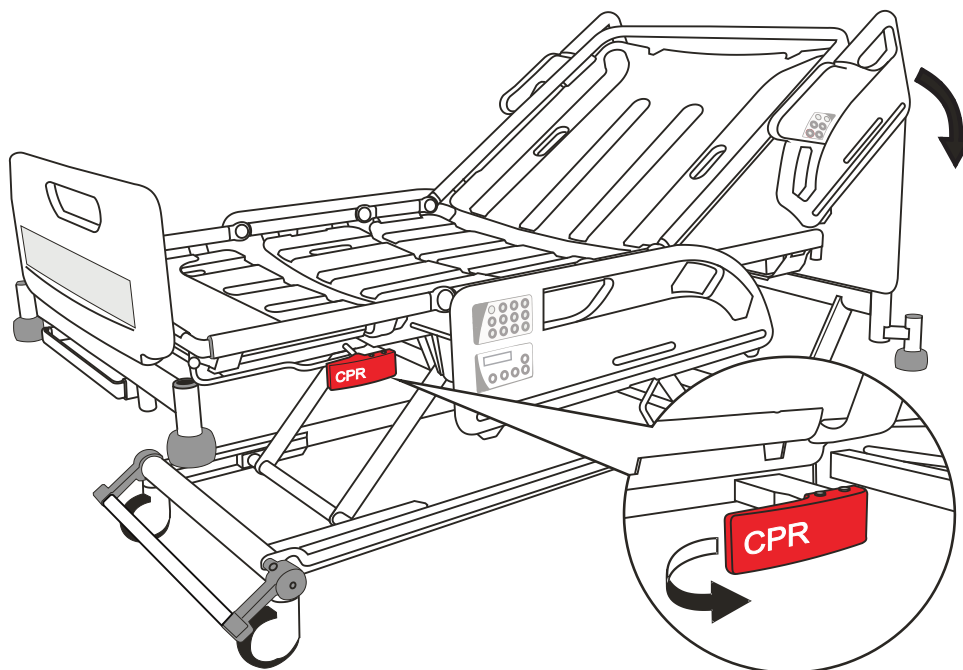

Pull the red CPR handle located on either side of the bed to quickly lower the backrest.

## Brakes and steering

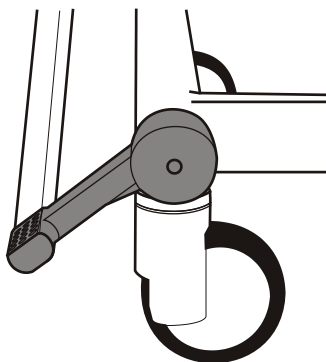

### Brake

Brakes applied on all four castors.

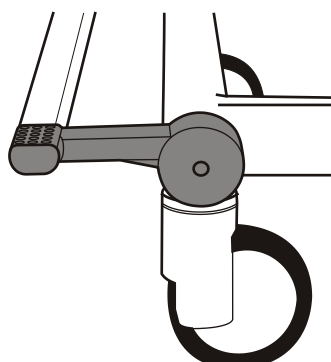

### Free

All four castors are free to rotate and swivel.

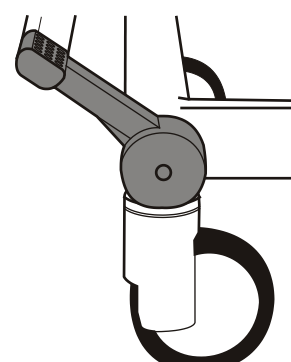

### Steer

All four castors can rotate, steering castor cannot swivel.

The brakes should be applied at all times when the bed is stationary.

## Side rails

1

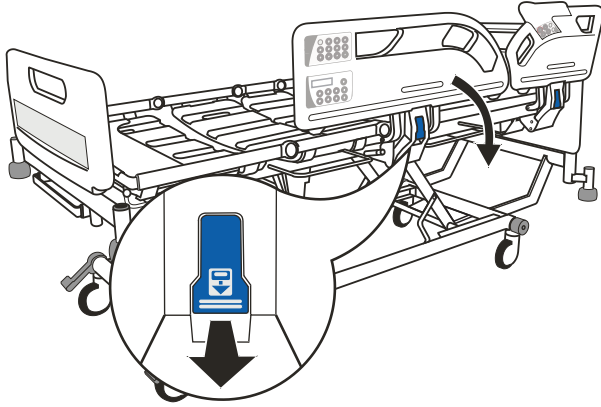

Pull blue release lever to lower the side rail.

2



Make sure the side rail is securely locked when in raised position.

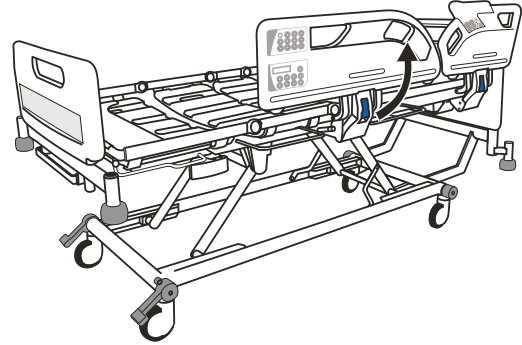

To raise side rail, hold side rail handle and pull side rail up and away from the bed until it locks in the raised position.

## Bed length adjustment (three set positions)

1

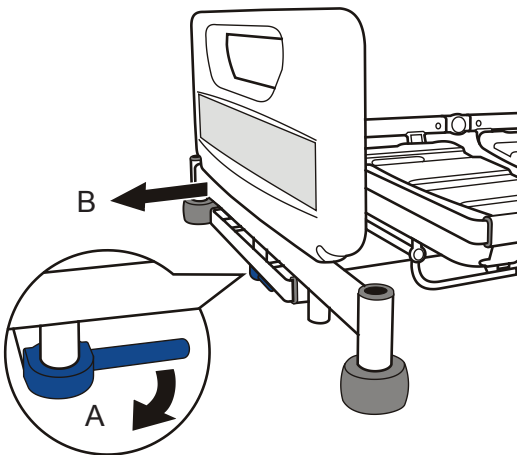

Pull the blue extension locking handle (A). Pull out the bed frame (B) to required position and release handle.

2

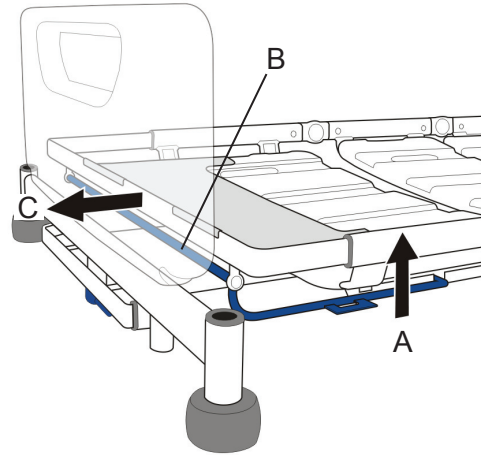

Lift the blue extension catch bar (A) and hold the middle of the crossbar (B), then pull the mattress platform to position (C).

## Calf section adjustment

1

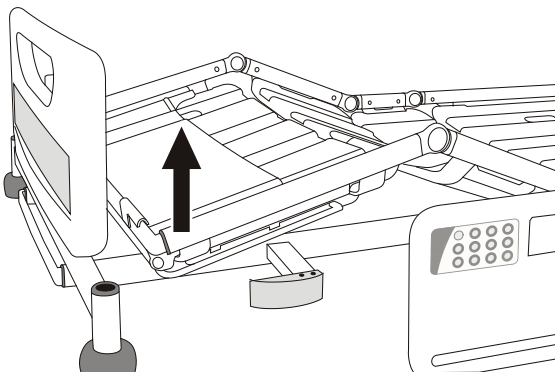

Hold side of the calf section frame and lift the calf section upwards.

2

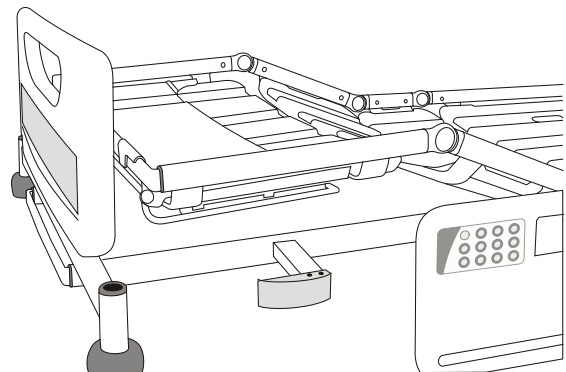

Lift until it latches in the horizontal position.